

PROWLER

SINGLE AXLE

1700RB



1700BH



1700DB



1702DBS



1802DBS



Floorplan	Total Exterior Length	Exterior Width	Exterior Height	Interior Height (Main)	Unloaded Vehicle Weight	Dry Hitch Weight	GVWR	Cargo Carrying Capacity	Fresh Water Capacity	Gray Waste Water Capacity	Black Waste Water Capacity	Sleeping Capacity
1700RB	21'-4 7/8"	8'	9' 4 1/2"	6'-5"	3,035	270	3,995	930	30 gal	20 gal	20 gal	up to 3
1700BH	21'-2 5/8"	8'	9' 5 5/8"	6'-6 1/8"	3,010	310	3,950	940	30 gal	20 gal	20 gal	up to 5
1700DB	TBD	8'	TBD	TBD	TBD	TBD	TBD	TBD	30 gal	TBD	TBD	up to 8
1702DBS	23'-7"	8'	10'-3 3/8"	6'-6 1/4"	3965	485	4,800	1,105	30 gal	39 gal	39 gal	up to 8
1802DBS	23'-7"	8'	9'-7 3/8"	6'-6"	4,045	610	4,995	950	30 gal	39 gal	39 gal	up to 6

PROWLER

STANDARD EXTERIOR EQUIPMENT

- 300 lb. rated single bunk beds
- 600 lb. rated double bunk beds
- Digital TV antenna
- Full-extension, heavy-duty ball-bearing drawer guides rated for 75 lbs.
- Residential-style high-rise kitchen faucet
- Marine-grade toilet with foot flush
- Plywood bed platforms
- Queen mattress
- Hidden residential-style cabinet door hinges
- Durable, residential-inspired kitchen countertops
- Shower curtain with curved shower track (available on certain models)
- Solid hardwood cabinet doors with hidden hinges and screwed stile construction
- Vinyl flooring throughout
- Vanity mirror with wood trim

STANDARD INTERIOR EQUIPMENT

- 8,000 BTU wall mount A/C (single axle models)
- 30 amp service
- Axles with electric, self-adjusting brakes and easy-lube hubs
- Exterior cable TV hookup
- Full-integrated A-frame
- Galvanized wheel wells
- Large exterior downspouts
- LP quick connect (n/a Lynx Edition models)
- TrusstXL Roof system (rated for 4500 lbs)
- Nitrogen filled radial tires
- PVC roofing membrane (limited lifetime warranty)
- Self-adjusting electric brakes

CAMPING IN COMFORT PACKAGE (Mandatory)

- 8 cu. ft. 12V refrigerator
- AM/FM/ Bluetooth® stereo
- Bathroom skylight
- Bathroom vent
- Detachable power cord
- Entry door with window and shade prep
- Fitted bed sheet
- G20 dark tinted privacy windows
- Large folding entry door grab handle
- LED interior and exterior lights
- Marine grade exterior stereo speakers
- Microwave oven
- MorRyde Step Above® entry steps
- Observation camera prep
- On demand tankless water heater
- Power awning with LED lights
- Range Hood
- Spare tire
- Stabilizer jacks
- Tub/shower surround
- Window shades

SELECT PACKAGE (OPTIONAL ON SELECT MODELS)

- Aluminum rims
- Decorative window surrounds in living area
- Dinette storage doors
- Fiberglass sidewalls
- Fireplace (n/a 2201MDS)
- Front accent LED lighting
- Pull-out kitchen faucet
- Window in slideout end wall

OPTIONS - SINGLE AXLE * OPTIONS VARY BY MODELS

- 13,500 BTU roof mounted A/C (standard on dual axle units)
- Outside griddle with LP quick connect hose (n/a on Lynx Edition models)
- PowerUp Solar 1 (200 watt solar panel with 30 amp solar controller, N/A on Lynx Edition Models)
- Fiberglass sidewalls
- Aluminum Rims
- Enclosed Underbelly (n/a on Lynx Edition models)

CAMPING IN COMFORT PACKAGE - Lynx Edition

- 12V refrigerator
- 19,000 BTU Furnace
- 2 - burner stovetop
- 20 lb. LP bottle
- Bathroom vent
- Detachable power cord
- Entry door with window and shade prep
- Tongue Jack
- Stabilizer jacks
- G20 dark tinted privacy windows
- LED interior and exterior lights
- Microwave oven
- On demand tankless water heater
- Power awning
- Rear bumper
- Window shades



Scan for more information
and full technical
specifications.



Meet your Heartland Dealer

Some specs at the time of print may include estimates. For the most updated information, please visit heartlandrvs.com

Heartland | 903 South Main Street | Middlebury, IN 46540 | Heartland - Part of Jayco Family of Companies

See dealer for further information and prices. All information in this brochure and on www.heartlandrvs.com is the latest available at the time of publication approval. Heartland reserves the right to make changes and to discontinue models without notice or obligation. Photography may show optional equipment or props used for decoration purposes only. RVs built for sale in Canada may differ to conform to Canadian codes. Printed in USA 7/16 ©2025 | 2032975

PROWLER

DOUBLE AXLE

2000MB



2201MDS

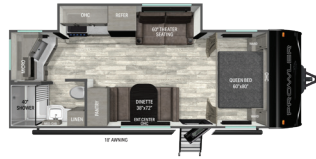

2103MKS



2100QB



2500BH



2600BH



2601RLS



2602BHS



2702BHS



3202DSB



3301RLT



Floorplan	Total Exterior Length	Exterior Width	Exterior Height (With A/C)	Interior Height (Main)	Unloaded Vehicle Weight	Dry Hitch Weight	GVWR	Cargo Carrying Capacity	Fresh Water Capacity	Gray Waste Water Capacity	Black Waste Water Capacity	Sleeping Capacity
2000MB	24'-7"	8' 5"	10'-6"	6'-9"	4,315	485	6,000	1,685	52 gal	39 gal	39 gal	up to 6
2201MDS	TBD	8'	TBD	6'-9"	TBD	TBD	TBD	TBD	52 gal	39 gal	39 gal	up to 3
2103MKS	24'-6 3/8"	8'	11'-1 1/4"	6'-9"	4,935	570	6,500	1,565	52 gal	39 gal	39 gal	up to 4
2100QB	25'-8"	8'	10'-6 1/2"	6'-9"	4,430	515	6,000	1,570	52 gal	39 gal	39 gal	up to 8
2500BH	27'-7"	8'	10'-2"	6'-6"	4,225	485	6,000	1,775	52 gal	39 gal	39 gal	up to 8
2600BH	29'-5"	8'	10'-5 3/4"	6'-9"	4,805	525	6,500	1,695	52 gal	39 gal	39 gal	up to 8
2601RLS	31'-3/4"	8'	11'-1"	6'-9"	6,715	810	7,900	1,725	52 gal	39 gal	39 gal	up to 6
2602BHS	30'-3 5/8"	8'	11'-3/4"	6'-9"	5,815	680	7,600	1,785	52 gal	39 gal	39 gal	up to 10
2702BHS	32'-6 3/4"	8'	11'-1"	6'-9"	6,270	755	7,900	1,630	52 gal	39 gal	71.5 gal	up to 10
3202DSB	36'-3 3/4"	8' 5"	11'-2 1/4"	6'-9"	7,705	1,080	9,600	1,895	52 gal	39 gal	39 gal	up to 10
3301RLT	37'-9 3/4"	8'	11'-1 1/2"	6'-9"	8,705	1,130	10,600	1,895	52 gal	39 gal	71.5 gal	up to 6

PROWLER

STANDARD EXTERIOR EQUIPMENT

- 300 lb. rated single bunk beds
- 600 lb. rated double bunk beds
- Digital TV antenna
- Full-extension, heavy-duty ball-bearing drawer guides rated for 75 lbs.
- Residential-style high-rise kitchen faucet
- Marine-grade toilet with foot flush
- Plywood bed platforms
- Queen mattress
- Hidden residential-style cabinet door hinges
- Durable, residential-inspired kitchen countertops
- Shower curtain with curved shower track (available on certain models)
- Solid hardwood cabinet doors with hidden hinges and screwed stile construction
- Vinyl flooring throughout
- Vanity mirror with wood trim

STANDARD INTERIOR EQUIPMENT

- 8,000 BTU wall mount A/C (single axle models)
- 30 amp service
- Axles with electric, self-adjusting brakes and easy-lube hubs
- Exterior cable TV hookup
- Full-integrated A-frame
- Galvanized wheel wells
- Large exterior downspouts
- TrusstXL Roof system (rated for 4500 lbs)
- Nitrogen filled radial tires
- PVC roofing membrane (limited lifetime warranty)
- Self-adjusting electric brakes

CAMPING IN COMFORT PACKAGE (Mandatory)

- 8 cu. ft. 12V refrigerator
- AM/FM/ Bluetooth® stereo
- Bathroom skylight
- Bathroom vent
- Detachable power cord
- Entry door with window and shade prep
- Fitted bed sheet
- G20 dark tinted privacy windows
- Large folding entry door grab handle
- LED interior and exterior lights
- Marine grade exterior stereo speakers
- Microwave oven
- MorRyde Step Above® entry steps
- Observation camera prep
- On demand tankless water heater
- Power awning with LED lights
- Range Hood
- Spare tire
- Stabilizer jacks
- Tub/shower surround
- Window shades

OPTIONS - DUAL AXLE * OPTIONS VARY BY MODELS

- Aluminum rims (standard with Select package)
- Fiberglass Sidewalls (standard with Select package)
- Theater seat (available on certain models)
- Tri-fold sofa (available on certain models)
- 2nd A/C with 50 amp service (available on certain models)
- 3rd A/C with 50 amp service (requires 2nd AC option, available on certain models)
- Free standing table with chairs (2601RLS and 3301RLT)
- King Bed (3301RLT)

SELECT PACKAGE (OPTIONAL ON SELECT MODELS)

- Aluminum rims
- Decorative window surrounds in living area
- Dinette storage doors
- Fiberglass sidewalls
- Fireplace (n/a 2201MDS)
- Front accent LED lighting
- Pull-out kitchen faucet
- Window in slideout end wall



For more information
and full technical
specifications,
scan our code.



Meet your Heartland Dealer

Some specs at the time of print may include estimates. For the most updated information, please visit heartlandrvs.com

Heartland | 903 South Main Street | Middlebury, IN 46540 | Heartland - Part of Jayco Family of Companies

See dealer for further information and prices. All information in this brochure and on www.heartlandrvs.com is the latest available at the time of publication approval. Heartland reserves the right to make changes and to discontinue models without notice or obligation. Photography may show optional equipment or props used for decoration purposes only. RVs built for sale in Canada may differ to conform to Canadian codes. Printed in USA 7/16 ©2025 | 2032975