



2025

# EDDIE BAUER

— CONVENTIONAL AND LAMINATED TRAVEL TRAILERS • FIFTH WHEELS —

LAUNCHING LIFE'S JOURNEYS

## ULTRA SMOOTH TRAVEL TRAILERS | TOP FEATURES

**RIDING IN STYLE** - Make a statement with aluminum wheels that enhance the visual appeal of your RV while providing a smoother ride.

**EASY SET UP, INSTANT ENJOYMENT** - Our EZ button setup simplifies your campsite preparation. Electric front jack, stab jacks, and awning make setting up camp a breeze, allowing you more time to relax and enjoy the great outdoors.

**INNOVATIVE DESIGN FOR ENHANCED STORAGE** - Our front profile offers superior aerodynamics, cutting through the wind and saving fuel. Plus, providing additional storage space for all your adventure gear and additional bedroom space.

**SLEEK AND STURDY AESTHETICS** - Immerse yourself in the beauty of ultra-smooth sided aluminum sidewalls with a .030 thickness surpassing competitors with exceptional strength and durability.



**PET HAVEN ON-THE-GO** - Embrace the joy of traveling with your pets. Our pet-friendly interiors feature built-in enclosures that provide your four-legged companions a secure and cozy space of their own.

**AUDIO ADVENTURE WITH A JBL SOUND SYSTEM** - Elevate your travel experience with the JBL stereo system offering premium sound quality both inside and outside your RV.

**A CULINARY OASIS** - Indulge in the convenience of a spacious 16 cubic foot residential-sized 12V refrigerator, real glass tile backsplash and high rise pull down faucet.

**CONVENIENCE AT ITS BEST** - Washer and dryer prepped closets (available in most models) ensure that your clothes and your pets' accessories remain fresh and clean throughout your journey.

**ENTERTAINMENT & COZINESS COMBINED** - Unwind in style with a 39" TV and fireplace, creating the perfect ambiance for relaxation after a day of adventures.



# ULTRA SMOOTH TRAVEL TRAILERS | FLOORPLANS



## 33FK

LENGTH 37'¾" | HEIGHT 11'2" | SLEEP CAPACITY 5-6  
 HITCH 1,262 LBS | DRY 7,940 LBS | GVWR 11,462 LBS



## 34BHS

LENGTH 38'5¼" | HEIGHT 11'2" | SLEEP CAPACITY 7-8  
 HITCH 1,102 LBS | DRY 8,824 LBS | GVWR 11,302 LBS



## 34BSBH

LENGTH 36'10¾" | HEIGHT 11'2" | SLEEP CAPACITY 7-8  
 HITCH 1,210 LBS | DRY 8,336 LBS | GVWR 11,410 LBS

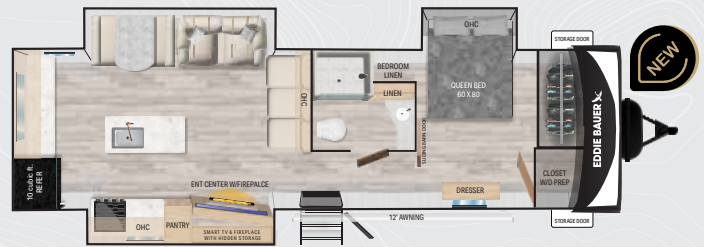

## 32MKS

LENGTH 35'10" | HEIGHT 11'2" | SLEEP CAPACITY 3-4  
 HITCH 734 LBS | DRY 8,688 LBS | GVWR 10,934 LBS



For more information and to take a virtual walk-through, visit [www.heartlandrvs.com](http://www.heartlandrvs.com)



## CONVENTIONAL TRAVEL TRAILERS | FLOORPLANS / FEATURES



### EBS 210RD

**Length** 26' 2 1/8" | **Height** 11' 0" | **Sleep Capacity** 5-6  
**Hitch** 520 LBS | **Dry** 4,240 LBS | **GVWR** 7,520 LBS



### EBS 251BH

**Length** 29' 6 1/4" | **Height** 10' 9" | **Sleep Capacity** 7-8  
**Hitch** 480 LBS | **Dry** 4,580 LBS | **GVWR** 7,480 LBS



**UNMATCHED OUTDOOR STORAGE** - Extra Large pass-through storage for all of your camping needs.

**READY, PREP, GO** - Every unit is prepped for Tire Pressure Monitoring, Rear Backup Camera, Ladder on the Go and Solar.

**FEEL THE DIFFERENCE** - Optimize cooling and energy conservation with dual air ducts and custom designed vents, that provide unmatched cooling power, optimal comfort and quieter operation.

**A CULINARY OASIS** - 10.7ft<sup>3</sup> 12V refrigerator and 3 burner stove top with oven, high rise faucet, and infinity edge pressed countertops.

**AT HOME COMFORT** - 80" Interior heights, with extra large windows that open, allowing added ventilation, True-flush floor slideouts and a carpet free environment.

**ELEMENT PROTECTION PACKAGE** - Coated slide-out floors, triple sealed slide-out openings, TPO roofing membrane, galvanized steel wheel wells.

**MASTER BEDROOM SUITE** - Residential 60" X 80" queen bed, designer bedspread, under bed storage, and built-in nightstands with CPAP compatibility. (most models)



### EBS 261BH

**Length** 31' 4 5/8" | **Height** 10' 9" | **Sleep Capacity** 7-8  
**Hitch** 600 LBS | **Dry** 5,700 LBS | **GVWR** 7,600 LBS



### EBS 300RK

**Length** 34' 5 5/8" | **Height** 11' 2" | **Sleep Capacity** 5-6  
**Hitch** 700 LBS | **Dry** 6,380 LBS | **GVWR** 9,500 LBS



### EBS 322BH

**Length** 36' 11" | **Height** 11' 4" | **Sleep Capacity** 7-8  
**Hitch** 700 LBS | **Dry** 6,840 LBS | **GVWR** 9,500 LBS

# LAMINATED TRAVEL TRAILERS | FLOORPLANS / FEATURES



## EBL 2510RL

**Length** 29' 10" | **Height** 11' 4" | **Sleep Capacity** 3-4  
**Hitch** 840 LBS | **Dry** 5,770 LBS | **GVWR** 7840 LBS



## EBL 2600RK

**Length** 32' 3 1/8" | **Height** 11' 4" | **Sleep Capacity** 3-4  
**Hitch** 1020 LBS | **Dry** 7,120 LBS | **GVWR** 9,820 LBS



## EBS 2610RB

**Length** 29' 8" | **Height** 11' 4" | **Sleep Capacity** 3-4  
**Hitch** 900 LBS | **Dry** 5,780 LBS | **GVWR** 7,900 LBS



## EBL 2800BH

**Length** 32' | **Height** 11' 4" | **Sleep Capacity** 7-8  
**Hitch** 980 LBS | **Dry** 6,140 LBS | **GVWR** 7,980 LBS

**UNMATCHED OUTDOOR STORAGE** – Extra large pass-through storage with oversized baggage door.

**READY, PREP, GO** – Every unit is prepped for Tire Pressure Monitoring, Rear Backup Camera, Ladder on the Go Prep and Solar Prep.

**FEEL THE DIFFERENCE** – Optimize cooling and energy conservation with dual air ducts and custom designed vents, that provide unmatched cooling power, optimal comfort and quieter operation. Combined with standard 15K BTU A/C and 50-Amp service for 2nd AC prep, give you everything you need to stay comfortable throughout your stay.

**BUILT TO LAST** – Automotive grade windshield and molded fiberglass front cap with custom designed graphics and Azdel Laminated fiberglass sidewalls give you unmatched protection from moisture and sound.



## EBL 2900RL

**Length** 31' 4 5/8" | **Height** 10' 9" | **Sleep Capacity** 7-8  
**Hitch** 1,140 LBS | **Dry** 7,480 LBS | **GVWR** 9,940 LBS



## EBS 3200BH

**Length** 36' 11" | **Height** 11' 8" | **Sleep Capacity** 7-8  
**Hitch** 1,200 LBS | **Dry** 8,320 LBS | **GVWR** 11,400 LBS



**A CULINARY OASIS** – 10.7 ft<sup>3</sup> 12V refrigerator and 3 burner stove top with oven, high rise faucet, and infinity edge pressed countertops.

**AT HOME COMFORT** – Smart TV, Bluetooth Speakers, 80" Interior heights, with extra large windows that open, allowing added ventilation, True-flush floor slideouts and a carpet free environment.

**ELEMENT PROTECTION PACKAGE** – Coated slide-out floors, triple sealed slide-out openings, TPO roofing membrane and galvanized steel wheel wells.

**MASTER BEDROOM SUITE** – Residential 60" X 80" queen bed, designer bedspread, under bed storage and built-in nightstands with CPAP compatibility (most models)

## SIGNATURE SERIES TRAVEL TRAILERS | FLOORPLANS / FEATURES

**EASY SET UP, INSTANT ENJOYMENT** - Our EZ button setup simplifies your campsite preparation. Electric front jack, Electric stabilizer jacks, and awning make setting up camp a breeze. Slideout Toppers also come standard and extend out automatically with the operation of the slideout, to keep you protected from the elements.

**INNOVATIVE DESIGN FOR ENHANCED STORAGE** - Our front profile offers superior aerodynamics, cutting through the wind and saving fuel. This design provides unique indoor and outdoor storage space for all your adventure gear.

**SLEEK AND STURDY AESTHETICS** - Automotive-grade painted cap with custom designed Eddie Bauer graphics and AZDEL laminated fiberglass sidewalls for increased protection from the elements.

**HOME AWAY FROM HOME** - Relax with features from home including a LED Smart TV, Electric Fireplace with Heat, Home Theater seating and Residential-Style Glass Shower Doors.

**AUDIO ADVENTURE WITH A JBL SOUND SYSTEM** - Elevate your travel experience with the JBL stereo system offering premium sound quality both inside and outside your RV.

**A CULINARY OASIS** - Indulge in the convenience of a spacious 16 cubic foot residential-sized 12V Refrigerator (Fifth Wheels Only), real glass tile backsplash and high-rise pull-down faucet and Apron Sink.

**CONVENIENCE AT ITS BEST** - Backup Camera comes standard along with Washer and dryer prepped closets (available in most models) ensure that your clothes stay fresh and clean throughout your journey and an On-Demand tankless Water Heater, so there is always hot water when you need it.

**EDDIE BAUER MASTER SUITE** - Catch up on sleep in a 72"x80" King Bed (N/A 2500RK & 3000BH), Designer Bedsreads and extra closet and storage space for anything you may need along the way.



### 2300RB

Length 26' 10" | Height 11' 4" | Sleep Capacity 3-4  
Hitch 760 LBS | Dry 5,700 LBS | GVWR 7,760 LBS



### 3311RL

Length 36' 11" | Height 11' 8" | Sleep Capacity 3-4  
Hitch 1,260 LBS | Dry 8,660 LBS | GVWR 11,460 LBS

# SIGNATURE SERIES FIFTH WHEELS | FLOORPLANS / FEATURES



## 2500RK

Length 28' 9 1/2" | Height 13' 4"  
 Hitch 1,877 LBS | Dry 8,725 LBS  
 GVWR 12,000 LBS | Sleep Capacity 3-4



## 3000BH

Length 34' 11" | Height 13' 2"  
 Hitch 1,332 LBS | Dry 9,530 LBS  
 GVWR 11,532 LBS | Sleep Capacity 7-8



## 3101RL

Length 35' 11" | Height 13' 2"  
 Hitch 2,256 LBS | Dry 10,903 LBS  
 GVWR 15,000 LBS | Sleep Capacity 3-4

**3600LF**  
 Length 41' 4" | Height 13' 4"  
 Hitch 2,442 LBS | Dry 12,238 LBS  
 GVWR 15,000 LBS | Sleep Capacity 5-6



## 3700MB

Length 41' 9" | Height 13' 2"  
 Hitch 2,493 LBS | Dry 12,592 LBS  
 GVWR 15,000 LBS | Sleep Capacity 7-8



For more information and to take a virtual walk-through, visit [www.heartlandrvs.com](http://www.heartlandrvs.com)



# SINGLE AXLE TRAVEL TRAILERS | FLOORPLANS / FEATURES

## LAMINATED (17BHL & 17RBL)

### INTERIOR

- 12V 3.3 Ft.<sup>3</sup> Refrigerator
- 60" x 80" Residential Mattress
- 20K Furnace
- 8K Roof Mount AC
- LED Batten Strip Interior Lights
- Range with 2 Burner Cook Top

### EXTERIOR

- AZDEL Laminated Sidewalls
- Diamond Plate Stone Guard
- JBL Stereo System
- Radial Tires
- Stabilizer Jacks
- Tankless Water Heater
- (1) 20LB LP Bottle

## CONVENTIONAL (17BH & 17RB)

### INTERIOR

- Fireplace
- LED Batten Strip Interior Lights
- Range with 2 Burner Cook Top
- Stabilizer Jacks
- 12V 3.3 Ft.<sup>3</sup> Refrigerator
- 60" x 80" Residential Mattress

### EXTERIOR

- 8K Roof Mount AC
- Diamond Plate Stone Guard
- JBL Stereo System
- Radial Tires
- Tankless Water Heater
- (1) 20LB LP Bottle

Both floorplans are available in laminated or conventional construction



### 17BHL

Length 20' 10 3/4" | Height 10' 4" | Sleep Capacity 5-6  
Hitch 420 LBS | Dry Weight 3,220 LBS | GVWR 3,920 LBS

### 17BH

Length 20' 10 3/4" | Height 10' 4" | Sleep Capacity 5-6  
Hitch 400 LBS | Dry Weight 3,052 LBS | GVWR 3,900 LBS



### 17RBL

Length 21' 1 1/4" | Height 10' | Sleep Capacity 3-4  
Hitch 482 LBS | Dry Weight 3,004 LBS | GVWR 3,880 LBS

### 17RB

Length 21' 1 1/4" | Height 10' | Sleep Capacity 3-4  
Hitch 412 LBS | Dry Weight 3,048 LBS | GVWR 3,912 LBS



HEARTLAND®



[www.heartlandrvs.com](http://www.heartlandrvs.com)

Your authorized Heartland dealer:

Product information is as accurate as possible as of the date of publication. Due to Heartland's commitment to continuous product improvement, floor plans, materials, components, features, measurements, specifications, options, etc. are subject to change at any time without notice or obligation. In certain conditions, some additional equipment may be needed. Photos may show optional equipment or props used for photography purposes only. Heartland has listed the approximate base weight of the trailer without the optional equipment included. Optional equipment will impact the weight of the trailer. Please locate the weight sticker attached to the trailer you are considering for the most accurate trailer weight. Tow Vehicle Caution: Owners of Heartland recreational vehicles are solely responsible for the selection and proper use of tow vehicles. All customers should consult with the motor vehicle manufacturer or their dealer concerning the purchase and use of suitable tow vehicles for Heartland products. Heartland disclaims any liability or damages suffered as a result of the selection, operation, use, or misuse of a tow vehicle. Heartland's limited warranty does not cover damage to the recreational vehicle or the tow vehicle as a result of the selection of the tow vehicle. Overall length for a Fifth Wheel is defined as the body length of the trailer excluding hitch meaning bumper to the cap. The overall length for a Travel Trailer is defined as the body length of the trailer including hitch, meaning bumper to hitch/pin. It does not include the rear ladder of the spare tire. Optional pin boxes will affect overall length. REV 12/24