



HEARTLAND | LAUNCHING LIFE'S JOURNEYS



TRAVEL TRAILER

2024

TRAIL RUNNER

TRAIL RUNNER | TOP FEATURES

LARGE ASSIST GRAB HANDLE & DROP DOWN SOLID ENTRY STEPS

- Designed to provide you with unparalleled stability without any bouncing or wobbling.

C-PAP VALET STORAGE

- Your ultimate companion for hassle-free CPAP device organization and care. Say goodbye to clutter and hello to convenience as you keep your sleep apnea therapy equipment in perfect order.

TRIO AIRFLOW AC SYSTEM

- Feel the difference with increased airflow, unmatched cooling power, and whisper-quiet operation.



DUAL SWING 12V RESIDENTIAL REFRIGERATOR

- Dual swing design offers easy access to your favorite chilled items, all powered by efficient 12V technology

POWER TONGUE JACKS, POWER AWNING, AND STAB JACKS

- Camping made easy with power stabilizer jacks and power lighted tongue jack (optional).

MOTION LIGHTS IN PASS THRU STORAGE

- Lighting to illuminate your pass-thru storage with a mere movement, making it easy to find and access your camping gear, tools, and supplies day or night.



For more information and to take a virtual walk-through, visit www.heartlandrvs.com



TRAIL RUNNER | FLOOR PLANS



171BH

LENGTH 20' 10 3/4" | **HEIGHT** 9' 1/2"
HITCH 386 LBS | **DRY** 3,016 LBS
GVWR 3,886 LBS | **SLEEP CAPACITY** 3 - 4



117R

LENGTH 20' 10 3/4" | **HEIGHT** 9' 1/2"
HITCH 400 LBS | **DRY** 3,032 LBS
GVWR 3,900 LBS | **SLEEP CAPACITY** 3 - 4



211RD

LENGTH 25' 8 1/2" | **HEIGHT** 11'
HITCH 626 LBS | **DRY** 4,278 LBS
GVWR 7,626 LBS | **SLEEP CAPACITY** 3 - 4



251BH

LENGTH 29' 6 1/2" | **HEIGHT** 11' 2" | **HITCH** 558 LBS
DRY 4,936 LBS | **GVWR** 6,900 LBS | **SLEEP CAPACITY** 7 - 8



255RL

LENGTH 29' 9" | **HEIGHT** 11' 2" | **HITCH** 664 LBS
DRY 5,616 LBS | **GVWR** 7,664 LBS | **SLEEP CAPACITY** 5 - 6



258RL

LENGTH 29' 9" | **HEIGHT** 11' 2" | **HITCH** 664 LBS
DRY 5,616 LBS | **GVWR** 7,664 LBS | **SLEEP CAPACITY** 5 - 6



261BHS

LENGTH 30' 5" | **HEIGHT** 11' 2" | **HITCH** 748 LBS
DRY 5,672 LBS | **GVWR** 7,600 LBS | **SLEEP CAPACITY** 7 - 8

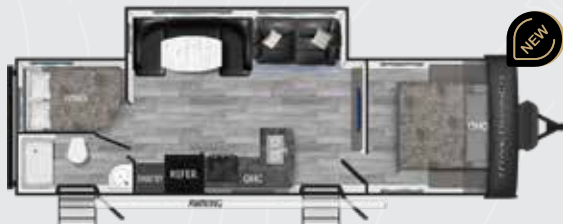

270BH

LENGTH 31' 11 1/2" | **HEIGHT** 11' 2" | **HITCH** - 748 LBS
DRY 6,086 LBS | **GVWR** 7,748 LBS | **SLEEP CAPACITY** 9+



27RKS

LENGTH 33' 11" | **HEIGHT** 11' 2" | **HITCH** 774 LBS
DRY 6,392 LBS | **GVWR** 9,574 LBS | **SLEEP CAPACITY** 5 - 6



30RBK

LENGTH 35' 5" | **HEIGHT** 11' 2" | **HITCH** - 722 LBS
DRY 6,590 LBS | **GVWR** 9,000 LBS | **SLEEP CAPACITY** 7 - 8



31DB

LENGTH 36' 11" | **HEIGHT** 11' 2" | **HITCH** 842 LBS
DRY 7,040 LBS | **GVWR** 9,642 LBS | **SLEEP CAPACITY** 7 - 8

MYHEARTLANDRV

MANAGE YOUR RV

Our new mobile app, allows Heartland owners to store their RV information, monitor warranty statuses, and access how-to videos and camping checklists on the go.

Available for download today.



Our Commitment to You: Travel should be about unforgettable experiences and cherished memories. At the heart of our promise to you lies comfort, quality, reliability and exceptional service. This means we focus on the details so you can concentrate on enjoying the journey of a lifetime.

Putting Customers First: Our dedication to outstanding customer service is more than a tradition, it's our driving force. Recently, we've enhanced our customer service capabilities with a new facility, advanced technology and increased staff training. This ensures that for every need, from service to parts and warranties, a team member is ready to assist.

Enhancing Facilities for Superior Craftsmanship: We continuously evolve, not just in our product offerings, but also in our facilities. By providing our team with the best resources, we ensure that they have everything needed to craft the highest quality RVs.

Building Product with the Customer in Mind: Our commitment to quality is the focus for every RV we build. With superior craftsmanship, thoughtful design and a rigorous internal process, we ensure that each RV is not just a product, but a beacon of our dedication, built with the customer at the forefront.

Premier Warranties: Our warranties set the bar in the luxury RV industry with a 1 year limited warranty covering defects + 3 Year limited structural warranty, reinforcing our commitment to long-term quality.

Valuing Our Community: The Heartland Owners' Group is more than just a customer base, it's a family. Their loyalty and enthusiasm do more for our brand than any advertising ever could. We cherish this community and treat every Heartland owner as a valued member of our extended family.



www.heartlandrvs.com



HEARTLAND®

Your authorized Heartland dealer:

Product information is as accurate as possible as of the date of publication. Due to Heartland's commitment to continuous product improvement, floor plans, materials, components, features, measurements, specifications, options, etc. are subject to change at any time without notice or obligation. In certain conditions, some additional equipment may be needed. Photos may show optional equipment or props used for photography purposes only. Heartland has listed the approximate base weight of the trailer without the optional equipment included. Optional equipment will impact the weight of the trailer. Please locate the weight sticker attached to the trailer you are considering for the most accurate trailer weight. Tow Vehicle Caution: Owners of Heartland recreational vehicles are solely responsible for the selection and proper use of tow vehicles. All customers should consult with the motor vehicle manufacturer or their dealer concerning the purchase and use of suitable tow vehicles for Heartland products. Heartland disclaims any liability or damages suffered as a result of the selection, operation, use, or misuse of a tow vehicle. Heartland's limited warranty does not cover damage to the recreational vehicle or the tow vehicle as a result of the selection of the tow vehicle. Overall length for a Fifth Wheels is defined as the body length of the trailer excluding hitch meaning bumper to the cap. The overall length for a Travel Trailer is defined as the body length of the trailer including hitch, meaning bumper to hitch/pin. It does not include the rear ladder of the spare tire. Optional pin boxes will affect overall length. REV 8/24