



NORTH TRAIL

TOP 5

EXTERIOR FEATURES

- 1 | Prepped for anything" - Tire pressure monitoring system, back up camera, solar and slide out topper prepped.
- 2 | Super King Kong sized pass-through storage
- 3 | Solar and Polar Package - 20 watt solar panel and charge controller
- 4 | 2" Azdel fortified sidewall construction
- 5 | Wide Trax Suspension for a smooth ride.

TOP 5

INTERIOR FEATURES

- 1 | Polar Shield Sidewall with tinted windows and nightshade.
- 2 | Butcher block style kitchen countertop
- 3 | Stainless steel appliances
- 4 | Value hide - E-center with hidden valuable storage area
- 5 | Comfort select 72" x 80" gel infused residential king bed mattress



NORTH TRAIL

| WEST COAST

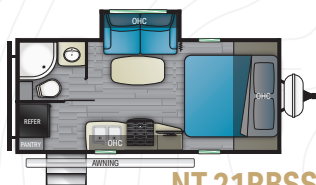

NT 21RBSS

LENGTH - 22' 1/2" | HEIGHT - 11' 4" | HITCH - 538 LBS.
DRY - 4,534 LBS. | GVWR - 6,900 LBS. | SLEEP CAPACITY - 3-4

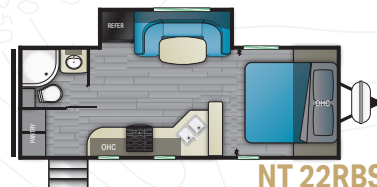

NT 22RBS

LENGTH - 26' 5-1/2" | HEIGHT - 11' 4" | HITCH - 700 LBS.
DRY - 5,260 LBS. | GVWR - 7,500 LBS. | SLEEP CAPACITY - 3-4

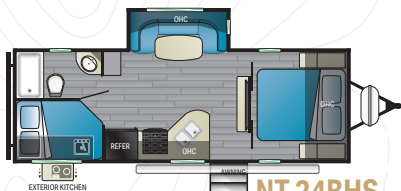

NT 24BHS

LENGTH - 27' 11" | HEIGHT - 11' 4" | HITCH - 550 LBS.
DRY - 5,400 LBS. | GVWR - 6,900 LBS. | SLEEP CAPACITY - 7-8

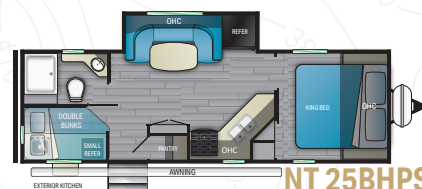

NT 25BHPS

LENGTH - 29' 4-1/2" | HEIGHT - 11' 4" | HITCH - 800 LBS.
DRY - 6,040 LBS. | GVWR - 7,800 LBS. | SLEEP CAPACITY - 8

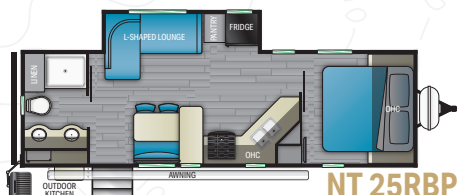

NT 25RBP

LENGTH - 30' 10-1/2" | HEIGHT - 11' 4" | HITCH - 700 LBS.
DRY - 6,278 LBS. | GVWR - 8,600 LBS. | SLEEP CAPACITY - 3-4

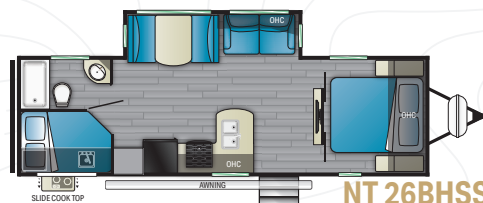

NT 26BHSS

LENGTH - 31' 11-1/2" | HEIGHT - 11' 4" | HITCH - 720 LBS.
DRY - 6,340 LBS. | GVWR - 9,520 LBS. | SLEEP CAPACITY - 7-8

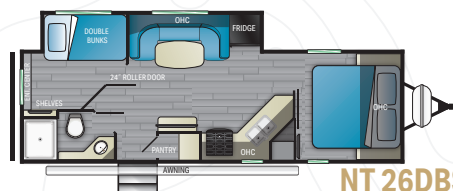

NT 26DBS

LENGTH - 30' 7-1/2" | HEIGHT - 11' 4" | HITCH - 820 LBS.
DRY - 6,380 LBS. | GVWR - 7,820 LBS. | SLEEP CAPACITY - 7-8

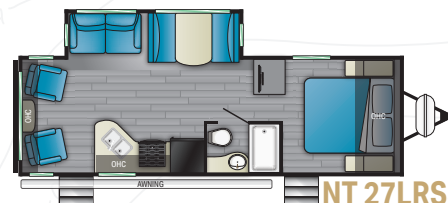

NT 27LRSS

LENGTH - 30' 1" | HEIGHT - 11' 4" | HITCH - 660 LBS.
DRY - 5,860 LBS. | GVWR - 7,660 LBS. | SLEEP CAPACITY - 5-6