

BIGHORN

BY HEARTLAND

*Outdoor Lifestyle,
Indoor Luxury*

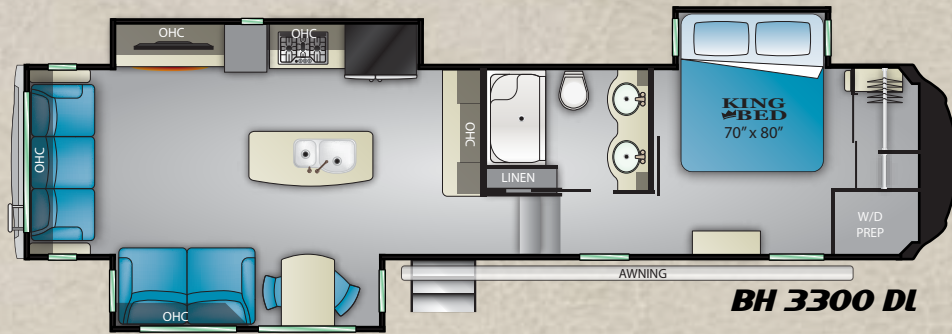



BH 3300 DL

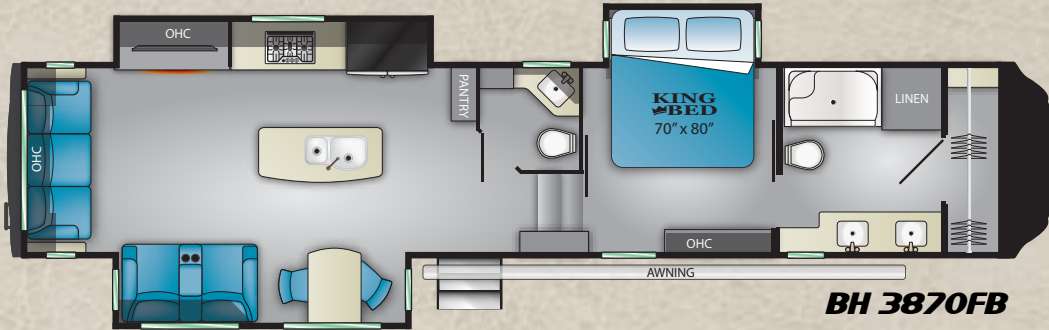
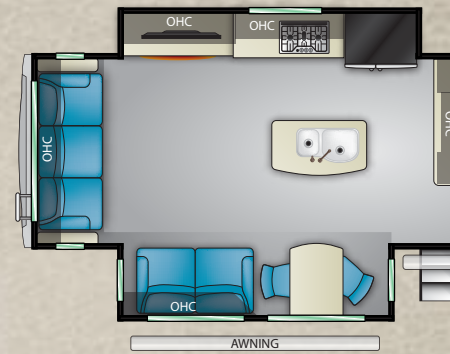

BH 3870 FB

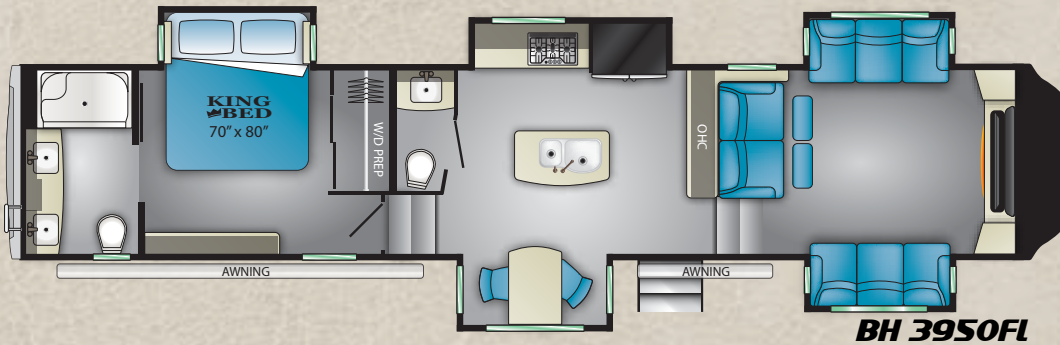

BH 3950 FL

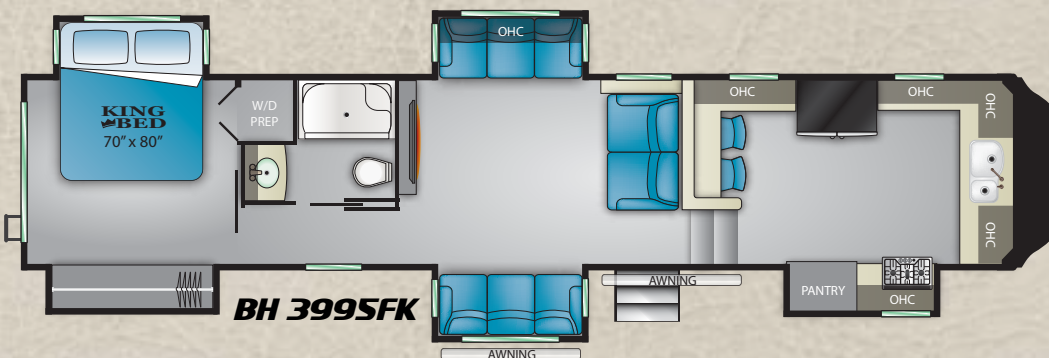
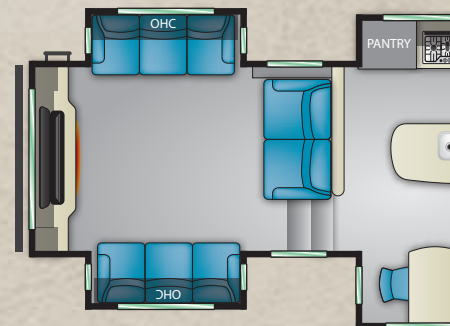

BH 3995 FK



BIGHORN

BY HEARTLAND

Model	3300DL	3375SS	3870FB	3930PC	3950FL	3985SRDD	3995FK
Length	39'0"	38'8"	43'0"	43'1"	43'10"	43'0"	43'10"
Dry Weight	12,277	13,268	13,955	13,468	14,238	14,079	14,141
Hitch Weight	2,330	2,580	2,885	2,720	3,675	2,945	2,907



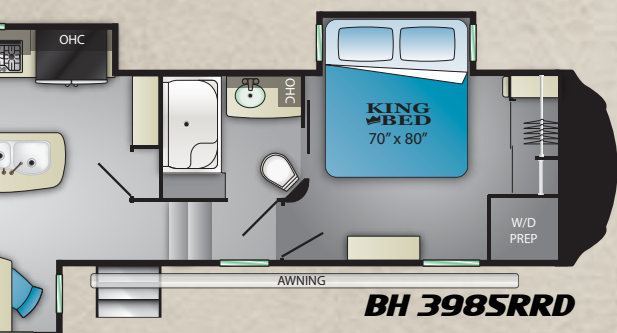
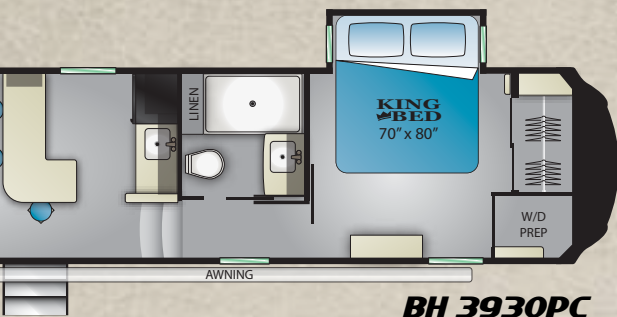
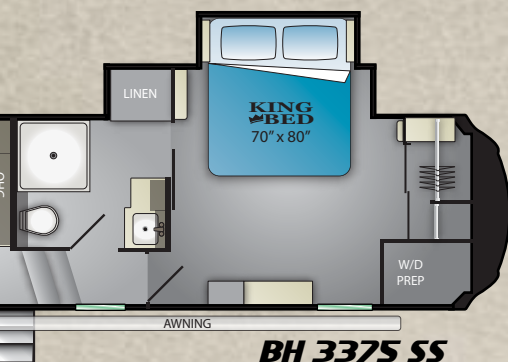

Standard Packages

King of the Mountain Package:

High-gloss fiberglass sidewalls with painted front cap
 6-point automatic hydraulic "Level Up" system
 Dexter axles
 MOR/ryde CRE3000 suspension and Nev R Adjust brakes
 Slam latch baggage doors
 50 Amp service
 Black tank flush
 Spare tire and carrier
 12gal DSI gas/electric water heater
 Exterior shower
 Universal Docking Station
 Drop frame storage
 Aluminum framed floor and sidewalls, roof and bath deck
 Electric awning with LED light strip
 Aluminum rims
 Battery disconnect
 Winegard Traveler satellite prep
 LED entry light
 Frameless windows
 Whisper Quiet 30,000BTU dual AC system
 Rear ladder
 Back-up camera prep
 Aluminum quad step entry
 18 cu.ft. gas/electric refrigerator

Premier Package:

Stainless steel appliances
 Power theatre seating with individually controlled massage/seat heaters
 5K BTU electric fireplace
 Solid surface countertops
 Ball bearing drawer guides
 Under-bed storage
 Fantastic fan with rain sensor
 Roller shades
 Hide-a-bed sofa
 55" LED flat screen TV with AM FM/CD/DVD player
 Washer/dryer prep
 Marble look shower
 Hidden hinges
 Upgraded king mattress
 Residential flooring
 Residential kitchen and bath faucet
 Legless dinette with 2 chairs and 2 folding chairs
 MY RV control system with Bluetooth and Wifi capability
 Hardwood bath steps
 Backlit headboard
 YETI cold weather package

Options

Full body paint (Black and Silver/ Crème and Silver)
 Dual Pane Frameless Windows
 Heat pump (Main or Bedroom AC)
 3rd 15K BTU air conditioner with power management system
 20 cu. ft. Stainless steel residential refrigerator
 32" LED TV in Bedroom

Fantastic fan in Bathroom
 Teak seat in shower
 Generator prep (forced with 5.5KW generator option)
 5.5KW Onan generator
 Slide awning package (3/4/5/6 depending on floor plan)
 2nd power awning on door-side with LED light

Optional Package

Diamond Elite Package:

Fiberglass rear cap
 Power cord reel
 Lighted badge on rear cap

4 Shock absorbers
 Power tilt king bed
 MOR/Ryde rubber pin box
 Euro entry door latch

BIGHORN

BY HEARTLAND



*Outdoor Lifestyle,
Indoor Luxury*



www.HEARTLANDRVs.com

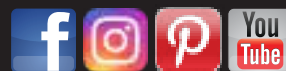

Product information is as accurate as possible as of the date of publication of this brochure. Due to Heartland's commitment to continuous product improvement, floorplans, materials, components, features, measurements, specifications, options, etc. are subject to change at any time without notice or obligation. In certain conditions some additional equipment may be needed. Photos may show optional equipment or props used for photography purposes only.

Heartland has listed the approximate base weight of the trailer without the optional equipment included. Optional equipment will impact the weight of the trailer. Please locate the weight sticker attached to the trailer you are considering for the most accurate trailer weight.

Tow Vehicle Caution: Owners of Heartland recreational vehicles are solely responsible for the selection and proper use of tow vehicles. All customers should consult with the motor vehicle manufacturer or their dealer concerning the purchase and use of suitable tow vehicles for Heartland products. Heartland disclaims any liability or damages suffered as a result of the selection, operation, use or misuse of a tow vehicle. Heartland's limited warranty does not cover damage to the recreational vehicle or the tow vehicle as a result of the selection of the tow vehicle.

30,000 Litho 1/20



Heartland Recreational Vehicles
2831 Dexter Drive
Elkhart, Indiana 46514
574-262-5992

Your Authorized Heartland Dealer: