

TRAIL RUNNER

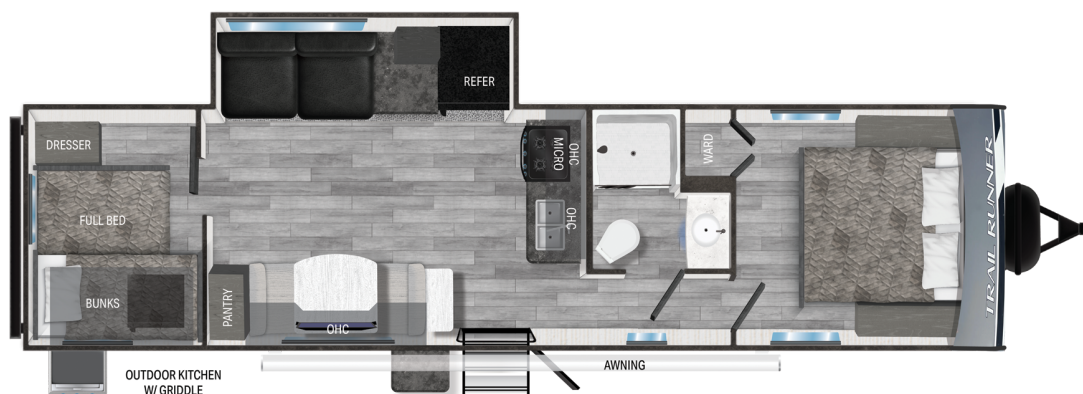

## TRAIL RUNNER 321BHQB

### TOP EXTERIOR FEATURES

Solid Entry Steps with Grab Handles  
C-PAP Valet Storage  
Exclusive Trio Airflow System

### TOP INTERIOR FEATURES

Dual Swing Residential Refrigerator  
Power Tongue Jacks  
Power Awning & Stab Jacks  
Motion Light in Pass Thru Storage

### PRODUCT SPECS

GVWR	9,680 lbs
DRY WEIGHT	6,840 lbs
HITCH WEIGHT	892 lbs
LENGTH	35'-11"
SLEEP CAPACITY	9+
AXLES	2 x 4,400 lbs
FRESH TANK	41 gal
BLACK TANK	40 gal

FURNACE	30,000 BTU
NUMBER OF SLIDES	1
BEDROOM HEIGHT	6'-8"
AWNING LENGTH	20'
COOK TOP	3 Burner
TRADITIONAL OVEN	Yes



2381 Dexter Drive • Elkhart, Indiana 46514  
574-262-5992 | [www.heartlandrvs.com](http://www.heartlandrvs.com)

\*Overall length defined as tow point (ball coupler for travel trailers / king pin for fifth wheel trailers) to rear bumper. It does not include rear ladder or spare tire. Optional pin boxes will affect overall length. \*\*Garage length is defined as ramp door to full interior wall. Standard or optional equipment may reduce overall garage dimensions. Information provided is accurate as of 9/17/20