

# TORQUE

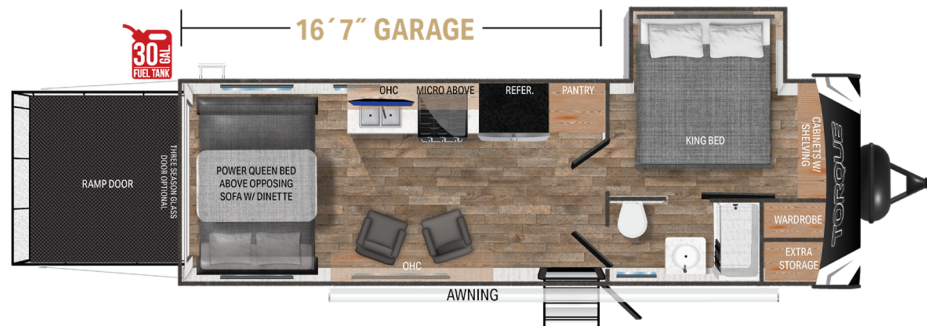

## T256

### TOP FEATURES

#### Top Exterior Features

- Outdoor Grill and Go with 18" of griddle cooking space
- Smooth Ride Suspension, including E-Rated tires, E-Z flex suspension with shock absorbers
- Rock Guard Galvanized steel in wheel wells
- Azdel Laminated Sidewalls. Lightweight, sound barrier and composite substrate.
- Easy entry solid step

#### Top Interior Features

- True 102" wide body with full height barrel ceilings
- JBL True Sound Stereo System with subwoofer
- Culinary Kitchen workspace with industry leading spacious countertops and residential microwave, and doodle station chalkboard
- We offer more 1/2 bath floor plans in our toy hauler garages than anyone in the industry
- New exclusive Air Fryer Oven with 3 burner Stove

### PRODUCT SPECS

Dry Weight	7424
Hitch Weight	1128
Axles	2 x 6000
Fresh Tank	98
Black Tank	30
Furnace	35,000 BTU
Number of Slides	1
Bedroom Height	7'-6"
Awning Length	19'
Cook Top	3 Burner
Traditional Oven	Yes
Convection Oven	No
Generator Prep	Optional



2831 Dexter Drive • Elkhart, Indiana 46514  
574-262-5992 | [www.heartlandrvs.com](http://www.heartlandrvs.com)

\*Overall length defined as tow point (ball coupler for travel trailers / king pin for fifth wheel trailers) to rear bumper. It does not include rear ladder or spare tire. Optional pin boxes will affect overall length. \*\*Garage length is defined as ramp door to full interior wall. Standard or optional equipment may reduce overall garage dimensions. Information provided is accurate as of 9/17/2020