

# PROWLER

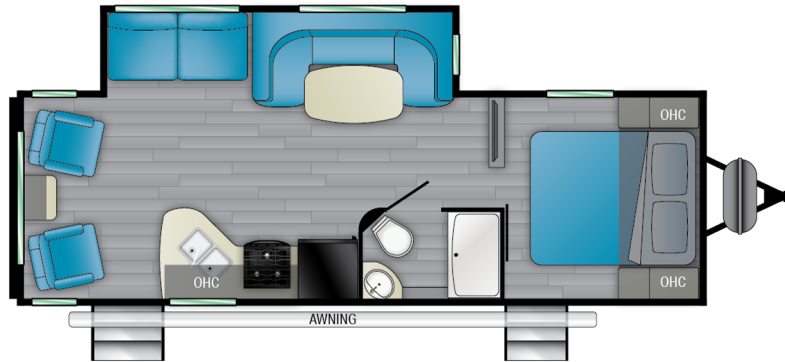

## Prowler 256RL

### TOP FEATURES

### PRODUCT SPECS

#### TOP 5 EXTERIOR FEATURES

- MEGA Bright Pass-Thru Storage - Unmatched Storage with 52 cu. ft of storage, mega sized access doors, LED lights on both sides and finished on the inside for protection.
- Easy Button Set Up - Camping Made Easy with power stabilizer jacks, adjustable power awning, and power lighted tongue jack (optional)
- Secure Access System - Secure fold out main entry step with adjustable legs, extra large top step and oversized fold out grab handle
- Performastructure Aluminum Front Wall - Superior Aero Performance for better wind and water deflection plus an aluminum front which is 60% thicker than most competitors
- Tailgate Package - LP Quick disconnect for your grill and TV hookup with exterior speaker - X

Dry Weight	6134
Hitch Weight	620
Axles	2 x 3500
Fresh Tank	41
Black Tank	40
Furnace	30,000 BTU
Number of Slides	1
Bedroom Height	6'-8"
Awning Length	20'
Cook Top	3 Burner
Traditional Oven	Yes
Convection Oven	No
Generator Prep	N/A

#### TOP 5 INTERIOR FEATURES

- H Blast AC - Unmatched Cooling Performance up to 50% more A/C ducts for better and more efficient air circulation
- Prowler Super Den - Full size residential queen bed, full length dual wardrobes, integrated lighting, USB charging and CPAP storage

**HEARTLAND**  
outs

2831 Dexter Drive • Elkhart, Indiana 46514  
574-262-3992 | [www.heartlandrvs.com](http://www.heartlandrvs.com)

maximum ventilation and view

\*Overall length defined as tow point (ball coupler for travel trailers / king pin for fifth wheel trailers) to rear bumper. It does not include rear ladder or spare tire. Optional pin boxes will affect overall length. \*\*Garage length is defined as ramp door to full interior wall. Standard or optional equipment may reduce overall garage dimensions. Information provided is accurate as of 9/17/2020