

# LYNX

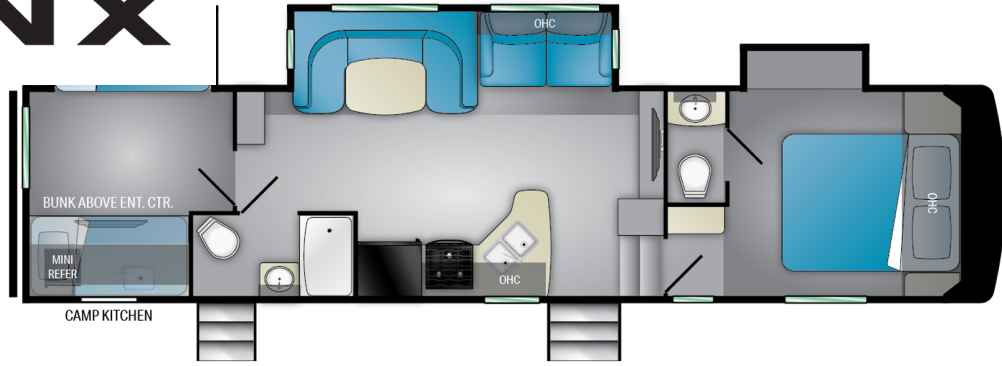

## 327

### PRODUCT SPECS



2381 Dexter Drive • Elkhart, Indiana 46514  
574-262-5992 | [www.heartlandrvs.com](http://www.heartlandrvs.com)

\*Overall length defined as tow point (ball coupler for travel trailers / king pin for fifth wheel trailers) to rear bumper. It does not include rear ladder or spare tire. Optional pin boxes will affect overall length. \*\*Garage length is defined as ramp door to full interior wall. Standard or optional equipment may reduce overall garage dimensions. Information provided is accurate as of 9/17/20