

LANDMARK

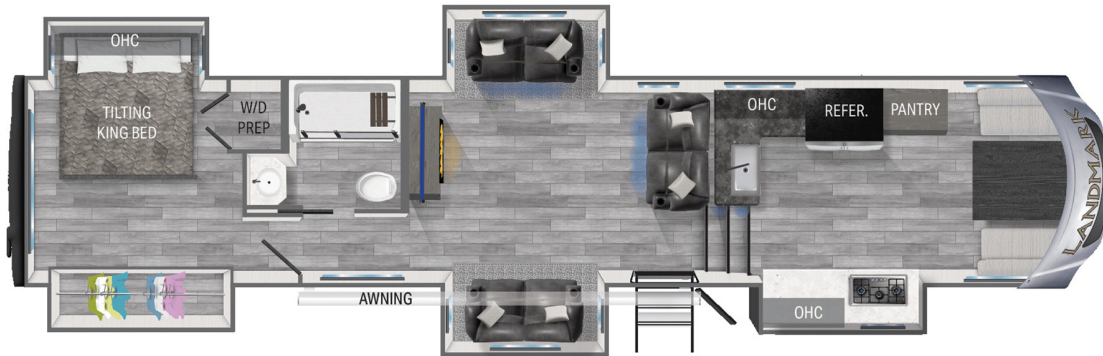

TUCSON

TOP EXTERIOR FEATURES

3-sided accessed basement with 30% more storage, clean paneled compartments and slam latch doors

"Hidden" main basement ceiling mounted MORryde tool tray

Azdel laminated sidewalls with non-wood substrate, sound barrier and insulation value

MORryde air compressor mounted door side with off door side quick connect port and 2.5 gallon tank

"Glide Ride" 8,000lb Dexter axles on H-range tires w/ 3 3/8" brakes, MORryde LRE 4000 and gas shocks

TOP INTERIOR FEATURES

In-Command multiplex coach controls including lighting, HVAC, dimmers, and more

Oversized walk-in closets with deep shelves, double hanging rods, cedar lining and washer/dryer cabinet

"Spa Baths" with solid surface sinks, marble look shower, removable shower head and teak wood seat

"Ultra-Upper Deck" bedroom with power tilting king bed, deep residential dressers and CPAP nightstands

"Tech-centric" dual supercharging USBs, bedroom USBs and 2 wireless charging stations in each unit, tire pressure monitor prep

PRODUCT SPECS

GVWR	18,000 lbs
DRY WEIGHT	15,657 lbs
HITCH WEIGHT	3,745 lbs
LENGTH	43'-10"
SLEEP CAPACITY	3-4
AXLES	2 x 8,000 lbs
FRESH TANK	80 gal
BLACK TANK	45 gal

FURNACE	35,000 BTU
NUMBER OF SLIDES	5
BEDROOM HEIGHT	7'-2-3/8"
AWNING LENGTH	17'
COOK TOP	3 Burner
TRADITIONAL OVEN	Yes
GENERATOR PREP	Standard



2381 Dexter Drive • Elkhart, Indiana 46514
574-262-5992 | www.heartlandrvs.com

*Overall length defined as tow point (ball coupler for travel trailers / king pin for fifth wheel trailers) to rear bumper. It does not include rear ladder or spare tire. Optional pin boxes will affect overall length. **Garage length is defined as ramp door to full interior wall. Standard or optional equipment may reduce overall garage dimensions. Information provided is accurate as of 9/17/20