

# CYCLONE

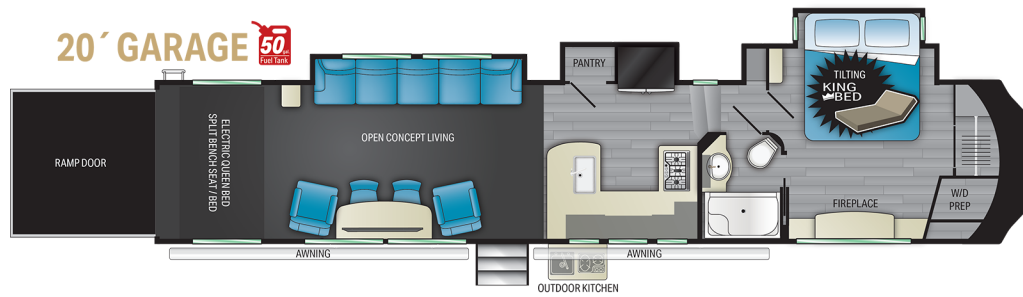

## Cyclone 4220

### TOP FEATURES

#### TOP 5 EXTERIOR FEATURES

- Patent pending Stor-Mor three-sided access to basement with 30% more capacity
- Armor Guard wrap around skirting
- Glow Technology Graphics
- Azdel laminated sidewalls and composite substrate creating a strong, lightweight, quiet, weather and temperature resistant wall that will increase the life of your RV.
- Ultimate outdoor kitchen combination

#### TOP 5 INTERIOR FEATURES

- **Swift Space**; work station creating a quick and convenient pull out dresser work station
- Maximum garage space with  $\frac{1}{2}$  bathroom folding door
- Tilting King bedroom suite with 30% more floor space
- Culinary kitchen work space
- Sunlight adjustable zebra shades

### PRODUCT SPECS

Dry Weight	16296
Hitch Weight	3995
Axles	3 x 7000
Fresh Tank	100
Black Tank	40
Furnace	35,000 BTU
Number of Slides	4
Bedroom Height	6'-4"
Awning Length	19'
Cook Top	3 Burner
Traditional Oven	Yes
Convection Oven	Yes
Generator Prep	Standard

